

# DAFFODIL PENDANT

Get that springtime feeling with this pendant adorned with daffodils.

By Julia Rai

Julia runs the Metal Clay Academy and teaches metal clay related classes around the UK and also online. She holds the prestigious Metal Clay Masters Registry credential at level four.

Daffodils are synonymous with spring and this pendant features three-dimensional daffodils on a curved triangular base. The two-piece cutter set used creates the petal elements and the lovely crinkle-edged 'trumpet' element.

Assembling the dry daffodil elements, which are only two cards thick, is fiddly but fun and the end result is worth the effort.

## MATERIALS

- 15g silver metal clay
- Silver clay paste
- Chain
- Textures
- Plastic 10ml measuring spoons
- Round-ended silicone clay shaper
- Daffodil midi cutter set
- Triangle cutter
- Cocktail stick
- Small steel files
- Paint brush
- Teflon sheet
- Dremel and radial bristle heads

## STEP 1

Oil the inside surfaces of small, plastic measuring spoons. Roll out silver clay two cards thick onto a sheet of smooth Teflon or onto a texture plate if you prefer. Each daffodil requires two petal cutouts and a central 'trumpet' piece so cut six petal shapes first. Place them into the spoons so they have a gentle curve. As the spoons are plastic, let the pieces dry naturally without heat.

## STEP 6

To assemble the petal part, dampen the centre back and the centre front of two petal elements. Put a blob of paste onto the centre front damp area and then stick the other petal element to this, making sure the petals are offset. Press down on the centre of the petals with the end of a paintbrush so they make good contact. Clean away any excess paste and dry.

## RESOURCES

**Daffodil cutter set:** [www.kitbox.co.uk](http://www.kitbox.co.uk)  
**Metal clay:** [www.metalclay.co.uk](http://www.metalclay.co.uk)  
**Radial bristle heads:** [www.chunungatree.com](http://www.chunungatree.com)  
**Chain:** [www.cooksongold.com](http://www.cooksongold.com)

## CONTACT

[www.juliarai.co.uk](http://www.juliarai.co.uk)  
[www.csacj.co.uk](http://www.csacj.co.uk)



### STEP 2

Roll out silver clay two cards thick and cut three trumpet forms using the other part of the daffodil cutter set. Cover the cut forms with cling film while you work on each trumpet. Using a round-ended silicone clay shaper or the oiled end of a paintbrush handle, gently form the trumpet shape, being careful not to squash the clay. Put the trumpet elements to dry on a hotplate.



### STEP 3

To make the main pendant base element, start by lightly oiling the outside of a plastic measuring spoon. Roll out the remaining silver clay to four cards thick on an oiled texture sheet. Texture the upper surface and cut a triangle shape for the pendant. Gently lay the triangle onto the oiled spoon making sure all the points make contact with the surface. Allow this to dry naturally without heat.

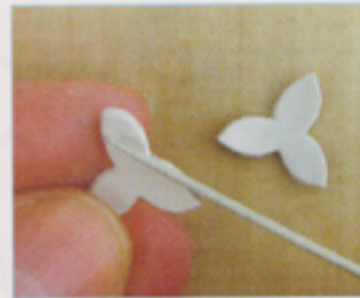

### STEP 4

When the petal elements are dry, refine all the edges with small diamond files. As these elements are only two cards thick they are very fragile, so handle the pieces carefully and support them well during the sanding process. Breakages are harder to fix in curved forms, so it is probably best to make another element if you break one or just make more than you need at the beginning.



### STEP 5

Texture the inside curved surface of the petals using thin paste. Paint the paste onto two petals and use a cocktail stick to scrape lines along the length of the petals. Dry on a hotplate. Once they are dry, texture the third petal in the same way and allow this to dry. When they are fully textured and thoroughly dried, sand off any stray lumps of paste from the edges.



### STEP 7

Refine the trumpet elements as necessary. To attach the trumpet elements, use a drill bit about the size of the base of your trumpet, probably around 2.5–3mm across. Drill a dip into the centre of the petal elements so the trumpet sits down into the dip. Dampen both surfaces and put a blob of thick paste into the dip, then stick down the trumpet. Clean any excess paste and dry.



### STEP 8

Refine the edges of the pendant base piece and attach a bail to the back. Dampen the surface of the base at one point of the triangle and the back of one daffodil. Put a blob of thick paste onto the base and stick down the daffodil. Clean off any excess paste and put to dry. When it's dry, repeat with the next daffodil, dry, then attach the final daffodil.



### STEP 9

Nestle the pendant piece in vermiculite or cushion with fibre blanket on a kiln shelf to maintain the curve. Kiln fire at 900°C for two hours or torch fire. When cool, polish the piece using radial bristles on a power tool. A three-dimensional piece is tricky to polish without a power tool and the radial bristles get into all the nooks and crannies. Thread a chain through the bail.

## Designer tips

- The midi sized daffodil cutter set is perfect for metal clay. Kitbox also do smaller and larger daffodil cutters.
- Plastic measuring spoons will soften and warp if you heat them so it is best to allow the forms to dry naturally when using this method.
- Always tie your hair back and remove any dangling clothes or jewellery when using spinning equipment like a Dremel for polishing. Safety glasses are essential too.

## Extra Projects Make earrings and a charm

Create a pair of earrings using the same technique. Either drill a hole in one of the petals for dangles or solder a post onto the back for studs. This technique is also good for charms. Drill a hole into one of the petals for a jumping and hang on a bracelet.

